

INSTALLATION INSTRUCTIONS

TRANSMISSION SWITCH KIT

**4 x 2 700-R4 to 350
Pickup, Passenger Car, Van**

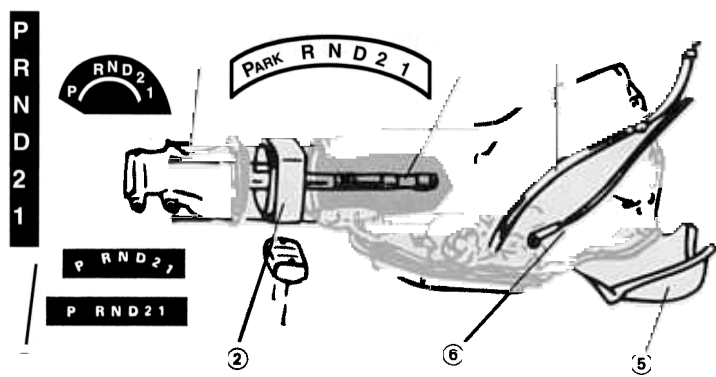

V-8

7-35B, V7-35B, 7-35C

1. Install output shaft (Item #1) furnished in a 350 Chevy, non lock-up transmission.

2. There are two extension housing O-rings furnished with the kit. One is to be placed on the front edge of the adapter block (Item #2) and the other on the original GM extension housing removed from the old 700-R4 unit.

3. Remove the inner speedo-gear, clip and drive shaft yoke seal housing (where used) from the old 700-R4 transmission just taken from the vehicle. This gear, clip, and seal now can be installed on the output shaft (Item #1).

4. Assemble the adapters as pictured: the adapter next to the 350 transmission case and then the 700 extension housing. Secure the adapter and extension housing with the four studs and nuts furnished (Item #3).

5. Install a 350 non lock-up converter. To use a 400 converter, change the flywheel. The larger flywheel is available from the Changeover Kit distributor.

6. Install the filler tube and stick (Item #4). The dust cover (Item #5), also should be attached at the time of installation. ON VANS, attach the upper dipstick tube half to the support bracket. Attach the lower half using a transmission-to-engine bolt. Use the heat shrink furnished to connect the two halves together.

7. On all units except Corvette, the transmission mount should be bolted to the bottom of the adapter (Item #2) with the two 3/8" x 5/8" bolts furnished.

8. Install Teckpak-Fitzall Detent Cable (Item #6).

9. On vehicles with dash-mounted selector indicator, the plastic indicator decal (Item #7) is installed by removing the screws that hold the dash into the cowl frame. The indicator plate will be visible. Wipe the indicator clean with alcohol or thinner! Use the right edge and the bottom of the decal as a guide. Peel off the back of the decal and press it firmly on the clean indicator. Reassemble dash. On floor shifters, remove the screws holding the indicator body. Turn plate over. Notice 2 star nuts holding the indicator in place. Remove these nuts. Place the decal over the existing indicator. Re-assemble the indicator plate and install indicator body on vehicle.

VAN: On vans, remove the selector indicator assembly from the column. Pull the rubber gasket off bottom of indicator. Next, pry the inner, clear plastic portion of the indicator out of the housing. Use lacquer thinner to remove the white painted indicator figures. Wipe the front of the decal area clean with thinner and stick the clear decal on the opposite surface of the original indicator figures. Reassemble and install. For cosmetic reasons, it may be desirable to purchase a new selector. The GM Non-Tilt Wheel number is 784101 and the Tilt Wheel number is 7840992.

10a. GAS ENGINE: To furnish vacuum to the transmission, use 3/16" tubing (brakeline or equivalent) approximately 3 feet in length. Hook this line into a vacuum source at the engine intake manifold and run the line down to the modulator. At an idle there should be 15 or more inches of vacuum at the modulator. If not, check your vacuum source. **NOTE: Do not use rubber vacuum tube from motor to transmission. It may heat up and collapse.**

10b. 6.2 DIESEL ENGINE: Remove the Throttle Position Sensor located on the injector pump. Replace this sensor with the transmission regulator GM Part #14057219. Tap into a vacuum line running from the vacuum pump and connect it to the vacuum regulator lower outlet; the one without the red cap. Remove the EGR vacuum line at the intake throat and plug it. You will then need to run a vacuum line from the vacuum regulator upper outlet: the one with the red cap, to the modulator.

11. After completing installation, take the vehicle for a test drive. It may be necessary to adjust the shift pattern by adjusting either the vacuum regulator (diesel only) or the modulator, or possibly both. For earlier shift, use GM Modulator #3035519.

The selector can be adjusted from under the vehicle by loosening the adjustment on the linkage coming down from the firewall.

Part Number	Length of Shaft
7-35B	18 1/2"
V7-35B	18 1/2"
7-35C	18 1/2"